

IQ7400HE-XF

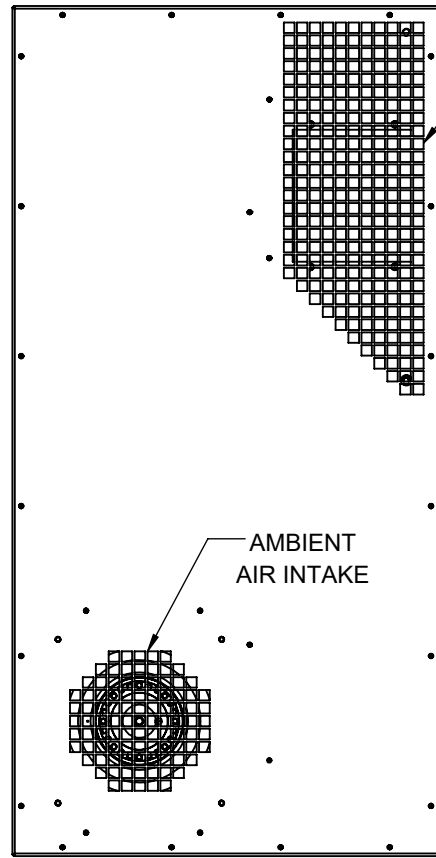

AMBIENT AIR EXHAUST

AMBIENT AIR INTAKE

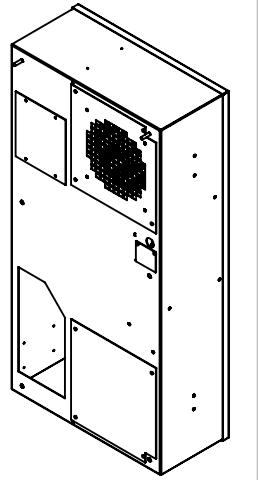
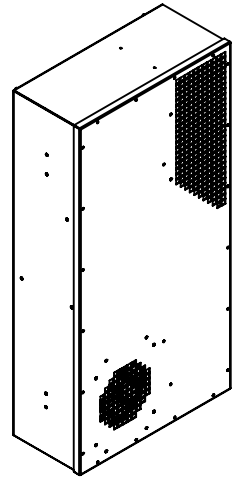
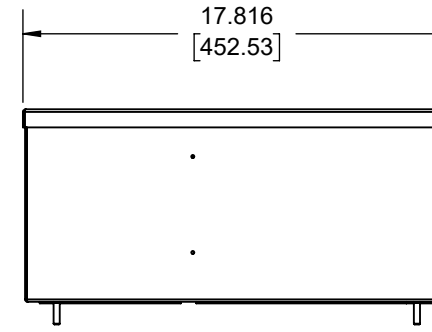

17.816
[452.53]

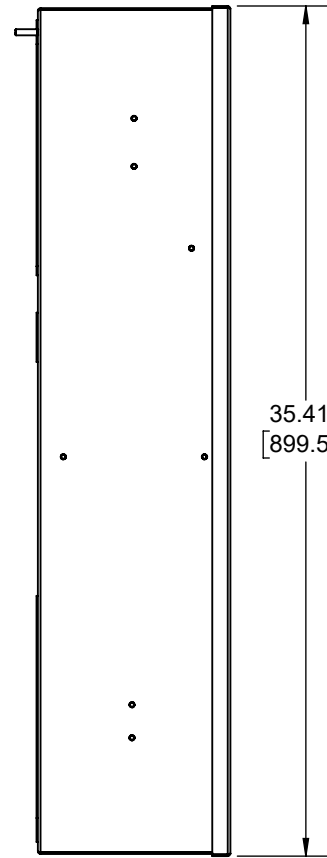

35.416
[899.57]

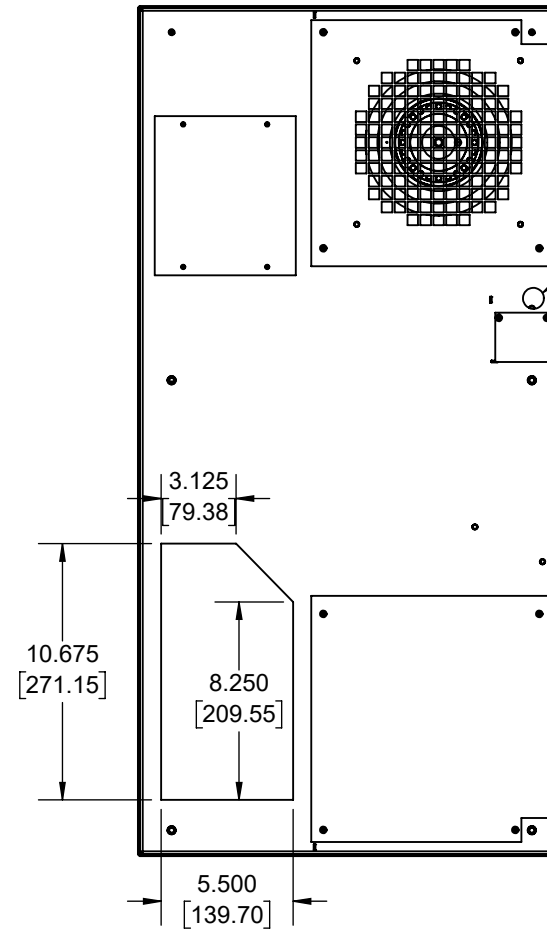

POWER INPUT

10.675
[271.15]

3.125
[79.38]

8.250
[209.55]

5.500
[139.70]

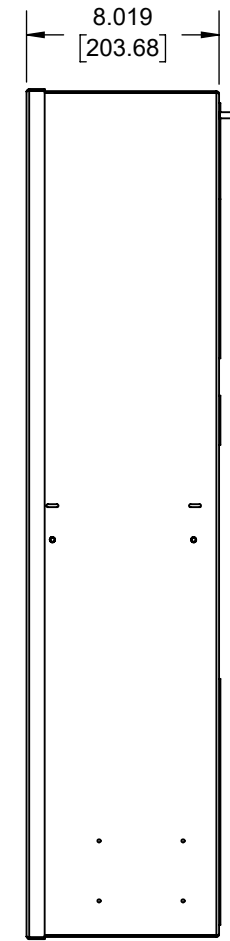

8.019
[203.68]

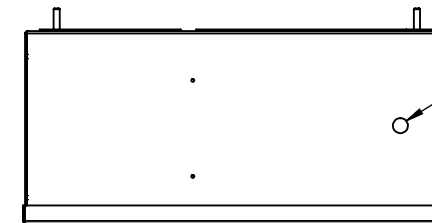

DRAIN HOLE

IQ7400HE-XF
 COOLING CAPACITY: 57 WATTS/°F
 MAXIMUM AMPS: 3.70A (444W) @ 120V/60HZ
 MAXIMUM AMPS: 1.80/1.40A (414/322W) @ 230V 60/50HZ
 MAXIMUM AMPS: 8.82A (212W) @ 24VDC
 MAXIMUM AMPS: 5.42A (260W) @ 48VDC
 MAXIMUM OPERATING TEMP: 176°F (80°C)
 DIMENSIONS: 35.42" (900MM) H X 17.82" (453MM) W X 8.02" (204MM) D
 WEIGHT: 74 LBS (33.6KG)

REV	CHG	DATE	APP	DATE	CN #
B		4/4/2019	ART		
A		11/30/2018	RCC		

ITEM NUMBER N/A	USED ON IQ7400HE-XF
MATERIAL N/A	
EST WT: lbs	
DRAWN BY RCC	DATE 11/30/2018
	SCALE 1:8

UNLESS OTHERWISE SPECIFIED TOLERANCES
.X ±.060
.XX ±.030
.XXX ±.015
FRACTIONAL ±1/16
ANGULAR ±1/2°
SURFACE FINISH 63
DO NOT SCALE DRAWING DIMENSIONS ARE INCHES

ICE QUBE, INC.
 THIS IS A PROPRIETARY DOCUMENT. DO NOT REPRODUCE OR DISCLOSE WITHOUT THE EXPRESS WRITTEN PERMISSION OF ICE QUBE, INC.

DESCRIPTION
IQ7400HE-XF SPEC DRAWING

DRAWING NUMBER
IQ280225

REV
B

