

SPEC DRAWING IQ150FPW
 155/134 CFM FREE AIR @ 120/110 VAC 60/50HZ
 155/134 CFM FREE AIR @ 230/220 VAC 60/50HZ
 MAXIMUM AMPS : 1.9/2.1 @ 120/110 VAC 60/50 HZ
 MAXIMUM AMPS : .75/1.0 @ 230/220 VAC 60/50 HZ
 MAXIMUM OPERATING TEMPERATURE :140°F

INTAKE CABINET

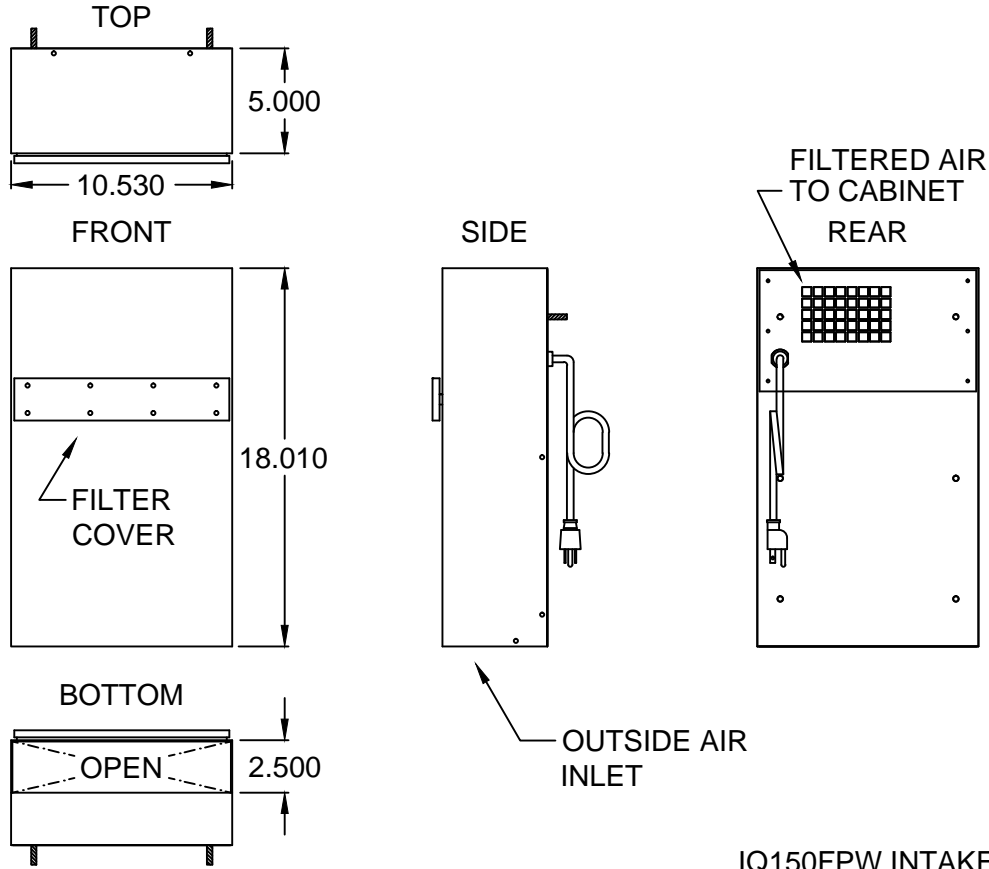

IQ150FPW INTAKE CUT OUT DRAWING

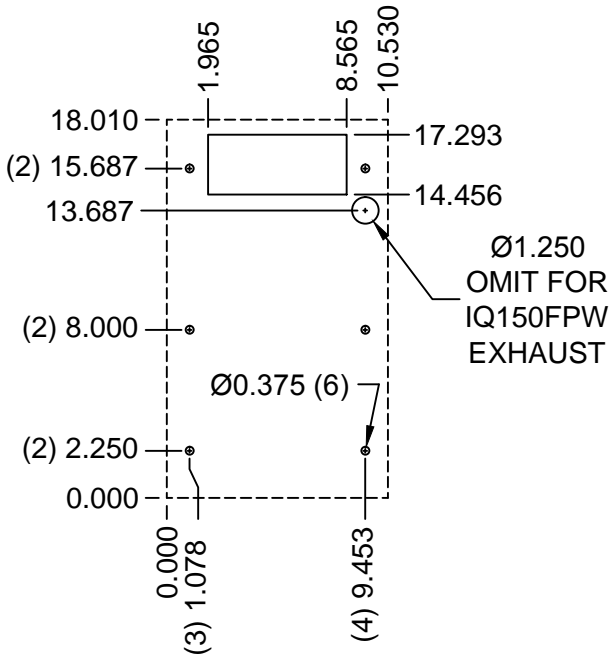

IQ150FPW INTAKE GASKET DRAWING

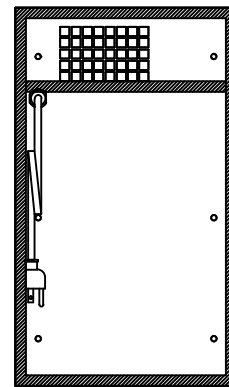

IMPORTANT
 GASKET MUST BE APPLIED AS SHOWN FOR PROPER OPERATION AND TO MAINTAIN NEMA INTEGRITY

0	INITIAL RELEASE	10-3-16	RCC
REV	DESCRIPTION	DATE	CHECKED
	REVISIONS		

PROPRIETARY DRAWING
 THIS DRAWING IS THE PROPERTY OF ICE QUBE, INC. AND IS NOT TO BE DUPLICATED OR ALTERED WITHOUT AUTHORIZATION OF ICE QUBE, INC.

DRAWN	GFD	SCALE	NONE
DATE	5-15-08		
SHEET 1 OF 2			

ICEqube INDUSTRIAL COOLING EQUIPMENT
 111 WILSON AVENUE GREENSBURG, PA 15601
 724-837-2204 * 1-888-867-8224 FAX: 724-837-3380
IQ150FPW
 IQ351156 0

EXHAUST CABINET

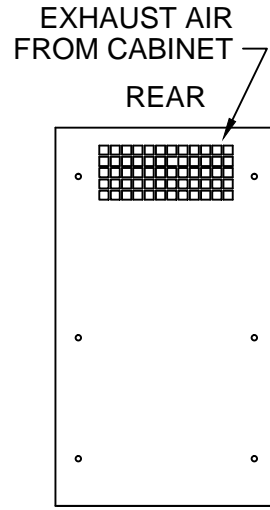
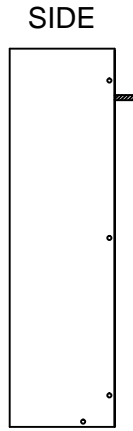
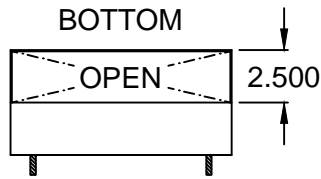
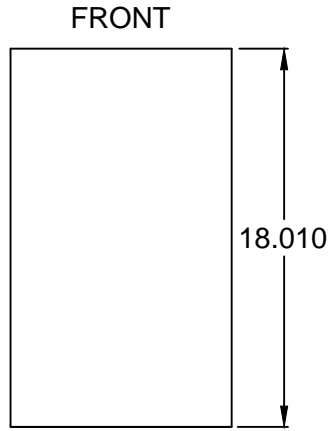
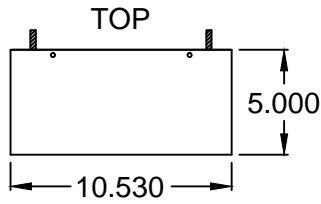

IQ150FPW EXHAUST CUT OUT DRAWING

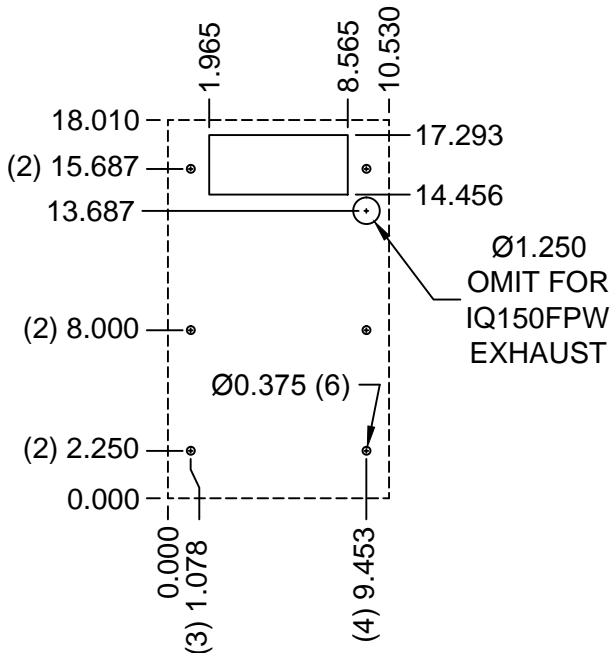

IQ150FPW EXHAUST GASKET DRAWING

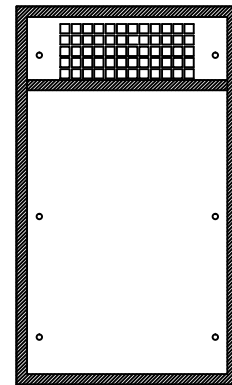

IMPORTANT
GASKET MUST BE APPLIED AS SHOWN FOR PROPER OPERATION AND TO MAINTAIN NEMA INTEGRITY