

IQ400FPP SPEC DRAWING

470/380 CFM FREE AIR @ 120/110 VAC 60/50 HZ  
 PUSH-PULL : 940/760 CFM FREE AIR @ 120/110 VAC 60/50 HZ  
 470/380 CFM FREE AIR @ 230/220 VAC 60/50 HZ  
 PUSH-PULL : 940/760 CFM FREE AIR @ 230/220 VAC 60/50 HZ  
 MAXIMUM AMPS : .70/.77 @ 120/110 VAC 60/50 HZ  
 PUSH-PULL : MAXIMUM AMPS : 1.40/1.54 @ 120/110 VAC 60/50 HZ  
 MAXIMUM AMPS : .34/.38 @ 230/ 220 VAC 60/50 HZ  
 PUSH-PULL : MAXIMUM AMPS : .68/.76 @ 230/ 220 VAC 60/50 HZ  
 MAXIMUM OPERATING TEMPERATURE : 176°F  
 WEIGHT: 5 LBS

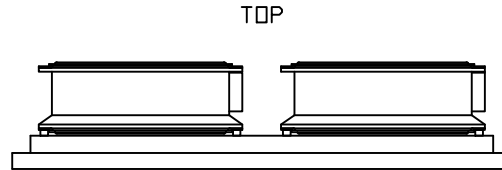

FRONT

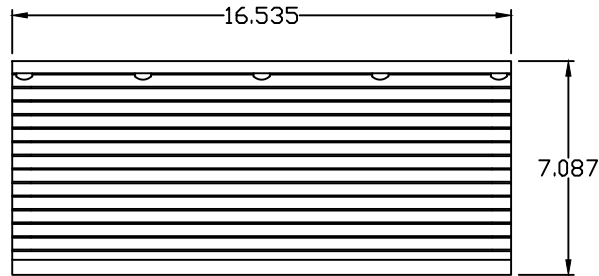

RIGHT SIDE

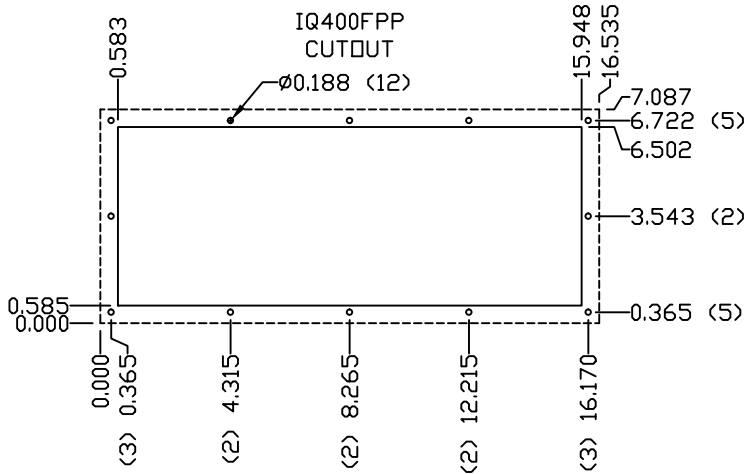
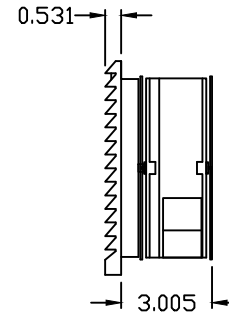

IQ400FPP REAR VIEW

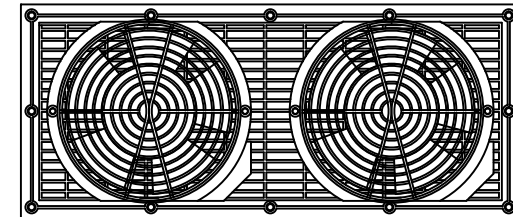

REV	DESCRIPTION	DATE	CHECKED
3	ADDED PUSH-PULL	6-12-17	RCC
2	UPDATED SPEC	2-10-10	JMH
1	UPDATED SPEC	11-14-08	JMH
0	INITIAL RELEASE	8-6-08	JMH

REVISIONS

PROPRIETARY DRAWING  
 THIS DRAWING IS THE PROPERTY OF ICE  
 QUBE, INC. AND IS NOT TO BE DUPLICATED  
 OR ALTERED WITHOUT AUTHORIZATION OF  
 ICE QUBE, INC.

DRAWN	JMH	SCALE	NONE
DATE	8-6-08	SHEET 1 OF 1	

INDUSTRIAL COILING EQUIPMENT 141 WILSON AVENUE GREENSBURG, PA 15601 724-837-8204 # 1-800-967-8234 FAX 724-837-3386	
ICEqube	
PART NAME IQ400FPP	
DWG NO IQ280803	REV 3